

# CABLELINE CLASSIC

## FEATURES

145 x 40mm Profiles

Three Compartments

Three Lids

- Screw-on corner fittings for added security.
- Accommodates 25mm deep boxes to accept a wide range of accessories.
- Unique slim-line design allows for installation in confined areas.
- Can be sub-divided
- Suitable for SO HO environments.



Cableline Classic - profile CL3 at dado level, profile CS3 at skirting level.

Standards: BS 4678-Pt4, BS7671 (IEE Regs), BS6701, BSEN50173, BSEN 50174-2, (CENELEC), ANSI/TIA/EIA 586B.

## SELECTOR CHART Choose from 3 distinct profiles.

Product	Length	Material	Colours/Finishes Available	Cableline Plus Compatible	Available as PowerTrack See Pages 28-29	Available Prewired See Pages 65-67	Compatible with Cidcline Wiring Accessories See Pages 50-55	Accepts Socket Mounting Boxes 25mm deep
CL3	3m	uPVC	Standard Colours: Alpine White Other Colour Options: RAL Colours	✓	✓	✓	X	✓
CS3	3m	uPVC		✓	✓	✓	X	✓
CP3	3m	uPVC		✓	✓	✓	X	✓

• Please contact our sales office for minimum quantities, lead times and price information.

## TRUNKING ASSEMBLIES AND FITTINGS

### Trunking Assemblies

Ref	Size	Packed
CL3	145 x 40mm	2 x 3m

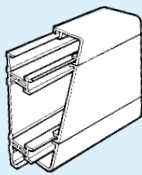

Ref	Size	Packed
CS3	145 x 40mm	2 x 3m

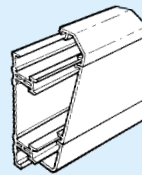

Ref	Size	Packed
CP3	145 x 40mm	2 x 3m

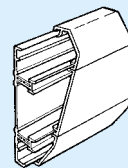

### External Angle Inc. continuity piece

Ref	To suit Classic Profile	Packed
CLX 3	CL3	1
CSX 3	CS3	1
CPX 3	CP3	1

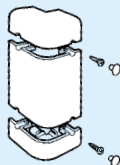

### Internal Angle

Ref	To suit Classic Profile	Packed
CLI 3	CL3	1
CSI 3	CS3	1
CPI 3	CP3	1



### Flat Angle

Ref	To suit Classic Profile	Packed
CLF 3	CL3	1
CSF 3C	CS3	1
CSF 3R	CS3	1
CPF 3	CP3	1

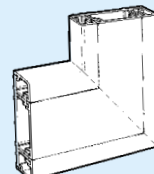

CSF 3C has a chamfered inner lid and a radius outer lid.  
CSF 3R has a radius inner lid and a chamfered outer lid.

### Flat Tee

Ref	To suit Classic Profile	Packed
CLT 3	CL3	1
CST 3	CS3	1
CPT 3	CP3	1

Includes one crossover unit Ref. CL03

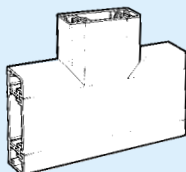

### Joint Cover

Ref	To suit Classic Profile	Packed
CLJ 3	CL3	2
CSJ 3	CS3	2
CPJ 3	CP3	2



### End Caps

Ref	To suit Classic Profile	Packed
CLS 3	CL3	2
CSS 3L	CS3 L.H.	2
CSS 3R	CS3 R.H.	2
CPS 3	CP3	2
Radius End Caps		
CLE 3	CL3	1

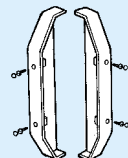

When a tee branch is taken off CS3 trunking use profile CP3 trunking.

## CL3

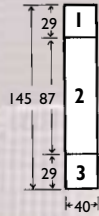

## CS3

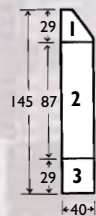

## CP3

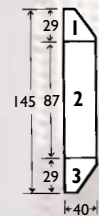

For cable capacity charts please refer to the Technical Section

## COMPONENTS (White unless shown otherwise)

### BOXES & FRAMES

#### Socket Mounting Boxes

Size	Ref	Packed
1 gang 25mm deep	CLB 3-1	10
1 gang vertical mounting box 25mm deep	CLB 3-1/4	10
2 gang 25mm deep	CLB 3-2	10

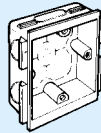

#### Screened Socket Mounting Boxes

Size	Ref	Packed
1 gang 25mm deep	CLBS 1	10
1 gang vertical mounting box 25mm deep	CLBS 1/4	10
2 gang 25mm deep	CLBS 2	10

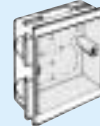

#### Extension Collars

Size	Ref	Packed
1 gang 10mm deep	CEC 110	10
1 gang 19mm deep	CEC 119	10
2 gang 10mm deep	CEC 210	10
2 gang 19mm deep	CEC 219	10

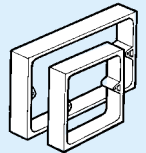

#### Mounting Frames

for 45 x 45mm Accessories

Type	Ref	Packed
1 gang	ATMF 451	15
2 gang	ATMF 452	10

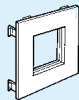

#### Socket Mounting Plate

Type	Ref	Packed
1 gang	CTMP 1	15
2 gang	CTMP 2	10

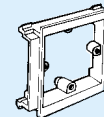

#### Mounting Frames

for Eunica Accessories

Type	Ref	Packed
1 gang	EAMF 1	15
2 gang	EAMF 2	10
2 x 1 gang	EAMF 3	10

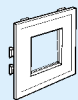

### ACCESSORIES

#### MCB/RCD Housing

Complete with DIN mounting rail & 2 Joint Covers

To suit	Ref	Packed
Profile: CL3, CS3, CP3 Housing Unit only	BCH 3	1
Housing Unit with Cover	BCHC 3	1

See Technical Section for MCB/RCD suitability.

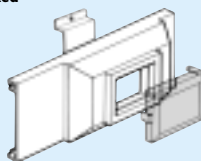

#### Screening Divider (Illustrated in Grey)

Size	Ref	Packed
23mm x 1mm	SS23	4x1.5m

For further details, please refer to the Technical Section.  
Other options are available.  
Contact us for further information.

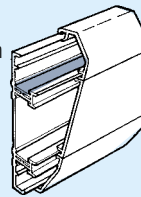

#### Rear Cable Entry Box

Ref	Packed
CBB3	1

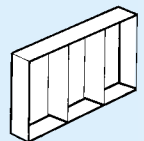

#### Mini Trunking Adaptors

Self Adhesive

Size	Ref	Packed
16 x 16mm	CLA 3-1	5
25 x 16mm	CLA 3-2	5

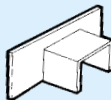

#### Cross Over Unit (Colour Red)

Size	Ref	Packed
For Classic	CLO 3	5

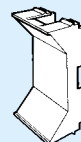

#### Cable Hanger (Colour Red)

Ref	Packed
CLH 3	10

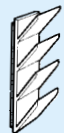

#### Cable Retainers

Type	Ref	Packed
Chamfered Outer	CSC3T	20
Centre	CLC3-M	10
Outer Radius	CLC3T	20

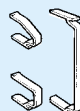

#### Decorative Flange

Ref	To suit	Packed
CLD 3	CL3	2
CSD 3L	CS3L	2
CSD 3R	CS3R	2
CPD 3	CP3	2



**PLEASE NOTE:** All drawings are for illustration purposes only.  
Fittings will vary according to profile selected.